

### **About your 121 Mobile Monitor . . .**

The Bose 121 Mobile Monitor with the supplied universal mount can be used in a variety of mobile and stationary applications. The procedures described in the 101™ Music Monitor System's owner's guide for unpacking, connecting, phasing, and maintaining speakers also apply to your 121 Mobile Monitor with the universal mount. Be sure to follow them carefully.

### **Before you begin . . .**

To properly install your 121 monitors in your vehicle, carefully read the directions in this supplement first, and then follow them carefully. You will need:

- Two sets per bracket of bolts and nuts, 3/16" (5 mm) diameter or larger, with washers, 1" (25 mm) minimum outside diameter
- Drill
- Hammer
- Pencil or other nonpermanent marker
- Center punch or nail set

### **Installing your 121 Mobile Monitor**

Please make sure to wear adequate eye protection and take all necessary electrical safety precautions when installing your monitors with power tools.



1. Select a mounting surface for your 121 monitors. **MAKE SURE THAT THE DESIRED SURFACE IS SAFE TO DRILL. AVOID MOUNTING SURFACES THAT MAY HAVE HAZARDS UNDERNEATH, SUCH AS ELECTRICAL AND FUEL LINES OR FUEL TANKS.**

# The Bose® 121™ Mobile Monitor Owner's Guide *Supplement*



**CAUTION**  
**BE SURE THE MOUNTING SURFACE YOU SELECT IS STURDY ENOUGH FOR MOUNTING THE SPEAKERS AND CAN WITHSTAND AT LEAST 150 LBS (70 Kg) AT EACH SPEAKER'S MOUNTING POINT.**

2. Locate where you want to place each mounting bracket, allowing room for the speakers. Hold the long part of one of the brackets in place on the surface where it is to be mounted. Trace the outline of the bracket holes onto the mounting surface, using a pencil or other nonpermanent marker. Be sure that the hole tracings are clearly visible.
3. Remove the bracket from the mounting surface. Use the center punch (or similar device such as a nail set) and a hammer to "dimple" the exact drill spot marked on the mounting surface. This will prevent the drill from wandering when you start drilling. Drill through the dimpled hole markings you have just made on the mounting surface. Be sure that your drill bit is appropriate for the mounting surface material. **DO NOT ATTEMPT TO USE THE MOUNTING BRACKET AS A DRILL GUIDE. PERSONAL INJURY COULD RESULT.**
4. Repeat Steps 2 and 3 for the second bracket.
5. Position each bracket over the holes, and mount them firmly to the mounting surface with the hardware specified above.

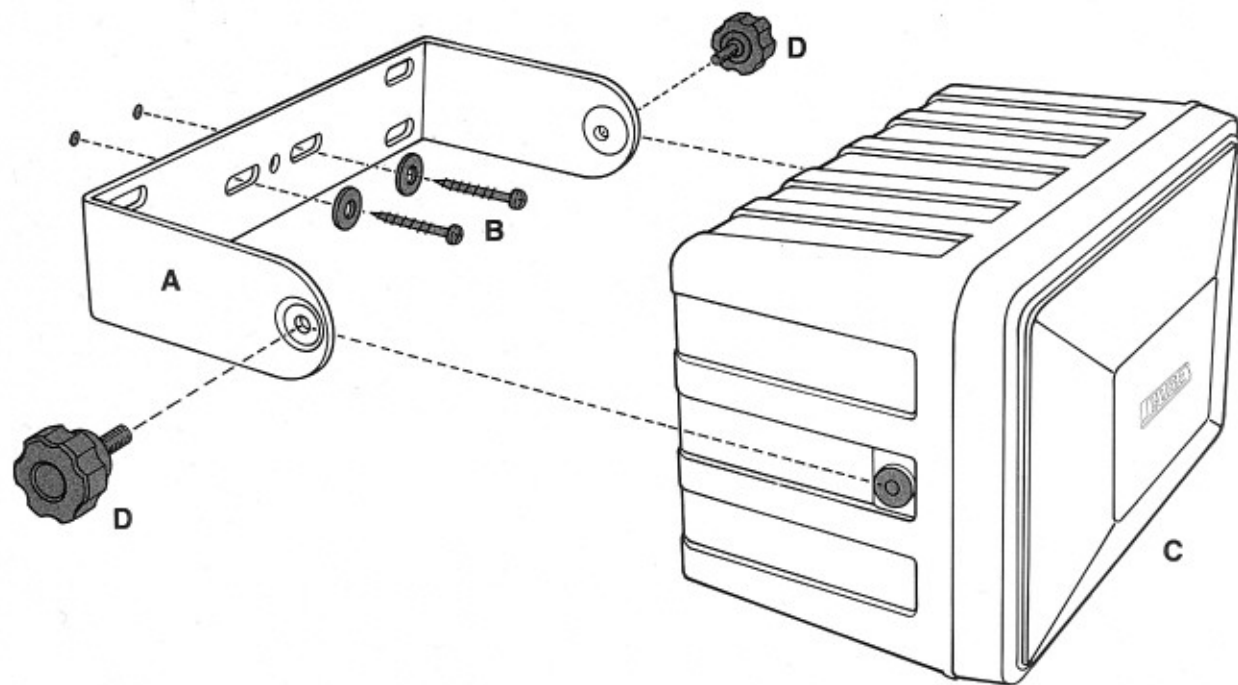

**Installing the Bose® 121™ Mobile Monitor:** The mounting bracket (A) is secured to the mounting surface by the recommended sized nuts, bolts and washers (B). The 121 Monitor (C) is then secured to the bracket by the supplied knurled knobs (D). Make sure that the lockwashers are in place on either side of the speaker, between the bracket and mounting holes.

6. Connect the speaker wire to the speaker terminals according to the instructions in your 121 Mobile Monitor System Owner's Guide.

**NOTE:**

Once the monitor is installed in the bracket, the connecting terminals will not be easily accessible. Therefore, it is generally easier to connect the speaker wire to the monitor terminals **BEFORE** mounting the monitor in the bracket.

7. Locate the tapped holes on either end of the 121 monitor. Place each monitor in the bracket so that these holes correspond to the holes on either end of the bracket. For best results, place the supplied lockwashers *between* the bracket and the side of the speaker at each hole prior to attaching the speakers. Attach the 121 monitors to the brackets using the supplied black knurled knobs. Your system is now ready to use.

**Using your monitor wisely**

The Bose 121 Mobile Monitor uses a high-technology HVC speaker that has been specially engineered to withstand extremes of moisture and power. However, some amplification systems (such as car stereos) are easily driven to distortion, which can cause damage to speakers. *This is especially true with low-powered amplifiers.* Therefore, avoid running your system at distortion-creating volume levels, and avoid the excessive use of tone controls, and/or equalizers.

**BOSE**  
Better sound through research.