

***BOSE***<sup>®</sup>



---

# RC-35S2 REMOTE CONTROL

---

Owner's Guide | Guía de usuario | Notice d'utilisation

# SAFETY AND REGULATORY INFORMATION

## Please read this owner's guide

Please take the time to follow the instructions in this owner's guide carefully. It will help you set up and operate your system properly and enjoy its advanced features. Please save this owner's guide for future reference.

## WARNINGS:

- Do not expose this apparatus to dripping or splashing, and do not place objects filled with liquids, such as vases, on or near the apparatus. As with any electronic products, use care not to spill liquids into any part of the system. Liquids can cause a failure and/or a fire hazard.
- Do not place any naked flame sources, such as lighted candles, on or near the apparatus.
- Keep the remote control batteries away from children. They may cause a fire or chemical burn if mishandled. Do not recharge, disassemble, heat above 100°C (212°F), or incinerate. Dispose of used batteries promptly. Replace only with batteries of the correct type and model number.



Please dispose of used batteries properly, following any local regulations. Do not incinerate.



廢電池請回收

## For RC-35S2-27 remotes in the U.S. and Canada

NOTE: This equipment has been tested and found to comply with the limits for a Class B digital device, pursuant to Part 15 of the FCC Rules. These limits are designed to provide reasonable protection against harmful interference in a residential installation. This equipment generates, uses and can radiate radio frequency energy and, if not installed and used in accordance with the instructions, may cause harmful interference to radio communications.

However, there is no guarantee that interference will not occur in a particular installation. If this equipment does cause harmful interference to radio or television reception, which can be determined by turning the equipment off and on, the user is encouraged to try to correct the interference by one or more of the following measures:

- Reorient or relocate the receiving antenna.
- Increase the separation between the equipment and receiver.
- Connect the equipment into an outlet on a circuit different from that to which the receiver is connected.
- Consult the dealer or an experienced radio/TV technician for help.

Changes or modifications not expressly approved by Bose Corporation could void the user's authority to operate this equipment.

Operation is subject to the following two conditions: (1) This device may not cause harmful interference, and (2) this device must accept any interference received, including interference that may cause undesired operation.

## For RC-35S2-27 remotes in Canada only

This Category II radio communication device complies with Industry Canada Standard RSS-310.

## For RC-35S2-27 or RC-35S2-40 remotes in Europe only

 Bose Corporation hereby declares that this product is in compliance with the essential requirements and other relevant provisions of Directive 1999/5/EC and other applicable Directives. The complete Declaration of Conformity can be found at [www.Bose.com/compliance](http://www.Bose.com/compliance).

## Overview

The RC-35S2 remote control is specifically designed to expand your Bose® LIFESTYLE® V25/V35 home entertainment system into another area of your home. Using the RC-35S2 remote control, you can listen to your main room system through a Bose link-enabled expansion product in another room.

LIFESTYLE®  
V25/V35 system  
(main room)

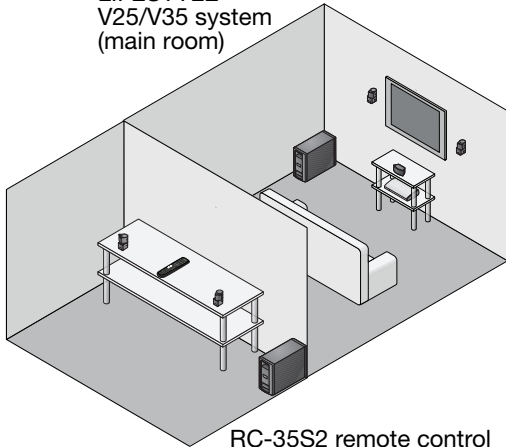

RC-35S2 remote control  
with expansion system

## Unpacking

Check the carton for the parts shown.



RC-35S2 remote control



Four  
AAA (IEC LR3)  
batteries



Homewide  
antenna

Save the carton and packing materials, which provide the safest way to transport this product.

If any part of the product appears to be damaged, do not attempt to use it. Contact your authorized Bose dealer immediately or call Bose Customer Service. Refer to the address list included with your LIFESTYLE® system for contact information.

## EXPANDING YOUR LIFESTYLE® SYSTEM

### Connecting your homewide antenna

Plug the antenna cable into the **Homewide Antenna** connector on your LIFESTYLE® system.

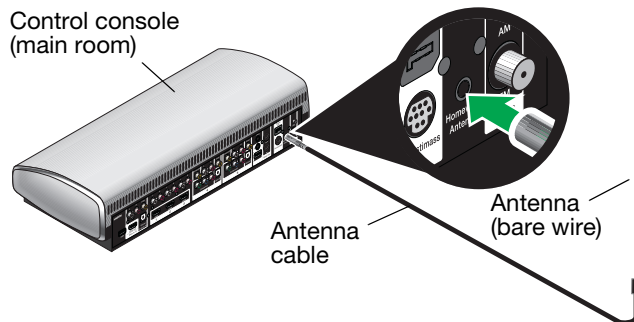

Because the antenna radiates at 90 degrees to the antenna (bare wire), mount the antenna vertically as close as possible to the center of the house.

**Do not bundle the antenna together with other cables and do not place it close to large metallic objects or surfaces.**

### Connecting an expansion product to the control console

1. Plug one end of the Bose® link cable into the **Bose link OUT** connector on your LIFESTYLE® system control console.

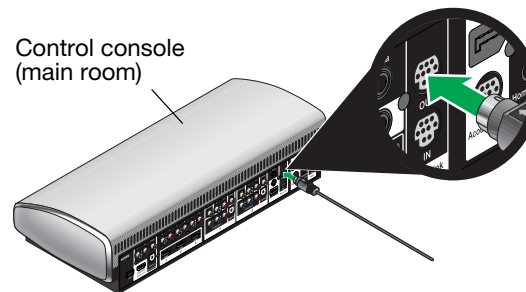

2. Connect the other end of the Bose link cable to your expansion product.

Your expansion product might be a speaker system or an AL8 Homewide Wireless Audio Link if you are making a wireless connection. Refer to the owner's guide that came with your expansion product for more information on making this connection.

## Getting the remote ready

---

1. Make sure your RC-35S2 remote and expansion product are set to the same room code.

The remote you received is set to room code B. If the expansion product is also set to room B, you do not need to do anything.

To change the remote control room code, see “Changing the room code” on page 8.

To change the room code in the expansion product, see the owner’s guide that came with it.

2. Make sure the house code in the RC-35S2 remote is the same as in your LIFESTYLE® V25/V35 home entertainment system.

Both products are initially set to house code 15 and should work together unless the house code in your main system was changed. To change the house code on the RC-35S2, see “Changing the house code” on page 9.

---

**Note:** For more information on changing the house code, see “Adding Sound to Another Room” in the operating guide for your LIFESTYLE® system.

---

## Installing the remote batteries

---

1. Press and slide the battery cover off the back of the remote.

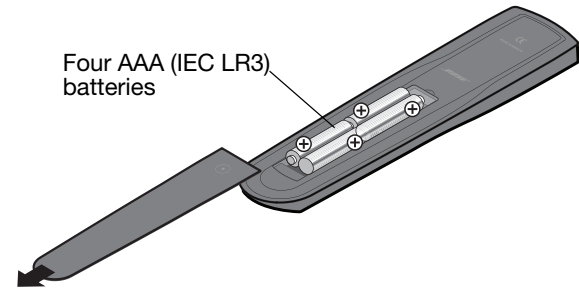

2. Install the four supplied batteries, matching the polarity markings (+ and -) on the batteries to the markings inside the battery compartment.
3. Slide the battery cover back into place until it snaps closed.

# USING THE REMOTE

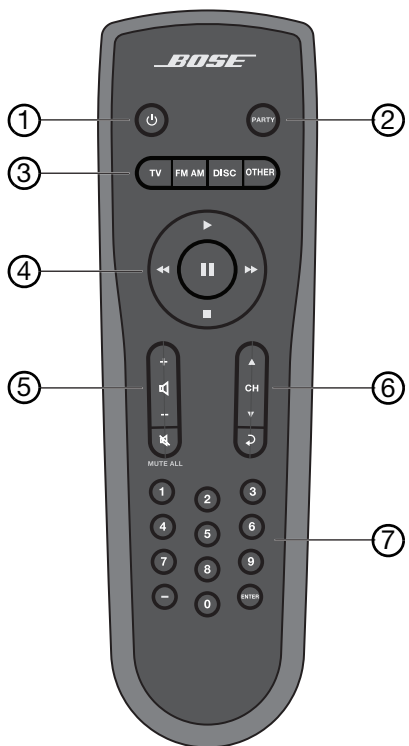

The RC-35S2 remote offers a simple set of controls that allow you to select sources and adjust audio playback in your expansion room.

## ① On/Off



Turns on/off your Bose® link expansion system.

When turning on your system, the source last selected is active.

## ② PARTY



Links all connected expansion products to the source playing on your LIFESTYLE® system in the main room. Can be used during a party when the same music is desired in multiple rooms.

### ③ Source selection

Using the RC-35S2 remote, you can select any device set up to work with your LIFESTYLE® system.

---

**Note:** To select any source other than AM/FM radio or an iPod, the source must be powered on.

---



Selects sources configured for TV viewing, such as a broadcast tuner in your TV and/or any set top boxes connected to the control console.

Each press switches to the next available source.



Selects the last FM or AM radio station selected.

Press again to toggle between FM and AM when the radio is on.



Selects disc devices connected to the control console, such as DVD, Blu-ray Disc™, and CD players.

Each press switches to the next available source.



Selects your iPod (if docked), other digital media players, or game consoles connected to the control console, as well as the last selected local source in the expansion room.

Each press switches to the next available source.

---

**Note:** A local source is a device, such as a TV or a portable CD or MP3 player, that is connected directly to audio input connectors on the expansion product.

---

iPod is a trademark of Apple, Inc., registered in the U.S. and other countries. All other marks are registered trademarks and trademarks of Bose Corporation.

## USING THE REMOTE

### ④ Playback controls

The playback controls allow you to operate devices connected to your LIFESTYLE® system such as a DVR, DVD/CD player, and docked iPod.

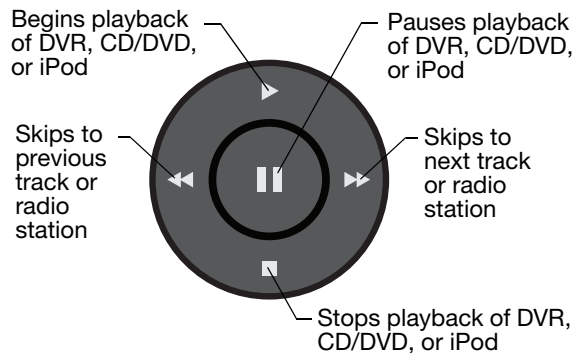

### ⑤ Volume controls





## ⑥ Channel controls



Changes to next/previous TV channel or radio preset.

If the source in use by the control console is a cable or satellite box connected to your TV, this moves to the next/previous cable or satellite channel.



Returns to last TV channel or radio station preset.

---

**Note:** If these controls do not seem to work with your TV, you may need to plug an IR emitter cable into the IR connector on the rear panel of the control console. IR cables are available from Bose. See the address list included with your LIFESTYLE® system for contact information.

Although the LIFESTYLE® system control console emits IR signals into the room where it is located, an IR emitter can better direct those signals to the TV.

---

## ⑦ Numeric keypad

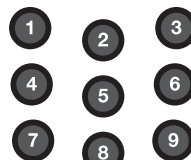

Selects a CD track, DVD chapter, radio station preset, or TV channel that corresponds to the numbers pressed.



Enters a dash or dot as necessary for a digital TV channel number.



Confirms channel selection on certain TVs.

# USING MULTI-ROOM AUDIO

## Room and house codes

Room and house codes are the settings that allow you to operate your main room system from another room in your home that has a Bose® link-enabled expansion system. Each RC-35S2 remote and your main room system must have identical house codes. Also, each expansion system and the RC-35S2 remote used with it must have identical room codes.

## Changing the room code

Your RC-35S2 remote is set at the factory for room code B. If room code B is already used by another Bose link product in your home, you need to change both the RC-35S2 and expansion system to another room code.

To change the room code in your RC-35S2 remote:

1. Press and slide the battery cover off the back of the remote.

2. Locate the room code switches (6-9).

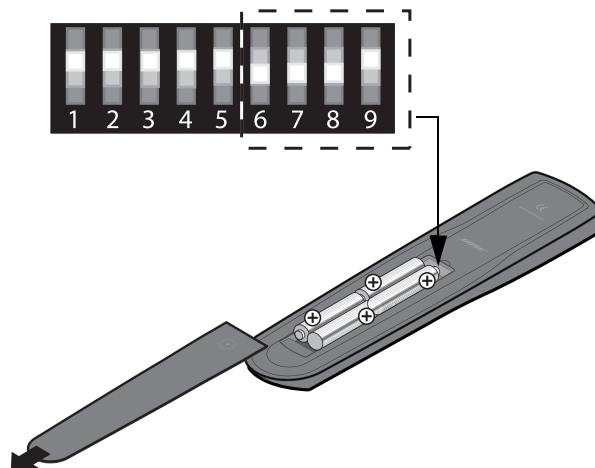

3. Select a room code from the following table.

Room Code	6	7	8	9
<b>B</b>	—	—	—	—
<b>C</b>	—	—	—	—
<b>D</b>	—	—	—	—
<b>E</b>	—	—	—	—
<b>F</b>	—	—	—	—
<b>G</b>	—	—	—	—
<b>H</b>	—	—	—	—
<b>I</b>	—	—	—	—
<b>J</b>	—	—	—	—
<b>K</b>	—	—	—	—
<b>L</b>	—	—	—	—
<b>M</b>	—	—	—	—
<b>N</b>	—	—	—	—
<b>O</b>	—	—	—	—

4. Using a fine-point pen or other small tool, set switches 6-9 to the corresponding up and down positions shown for that room code.
5. Slide the battery cover back into place until it snaps closed.

## Changing the house code

The radio frequency (RF) signals used in expansion systems have a long range and the ability to penetrate walls. Therefore, the signals from an RC-35S2 remote in one home can possibly reach and affect the operation of a LIFESTYLE® system in a nearby home. Changing the house code for the system and all the remotes used with it avoids possible conflict.

Your RC-35S2 remote is set at the factory for house code 15.

To change the house code in your RC-35S2 remote and in your LIFESTYLE® system:

1. Press and slide the battery cover off the back of the remote.

## USING MULTI-ROOM AUDIO

2. Locate the house code switches (1-4).

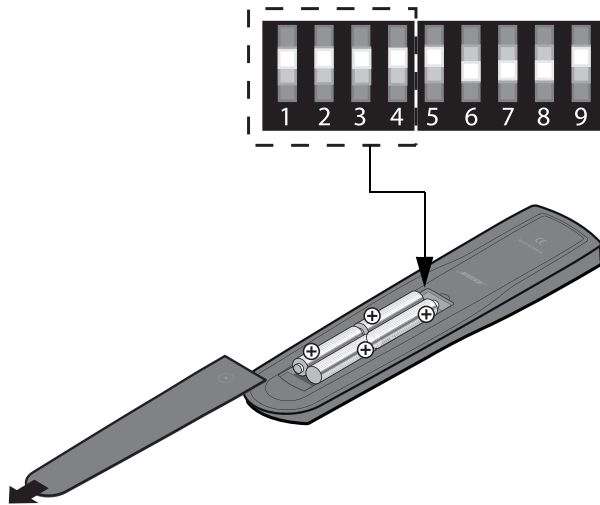

3. Select a house code from the following table.

House Code	1	2	3	4
0	—	—	—	—
1	—	—	—	—
2	—	—	—	—
3	—	—	—	—
4	—	—	—	—
5	—	—	—	—
6	—	—	—	—
7	—	—	—	—
8	—	—	—	—
9	—	—	—	—
10	—	—	—	—
11	—	—	—	—
12	—	—	—	—
13	—	—	—	—
14	—	—	—	—
15	—	—	—	—

4. Using a fine-point pen or other small tool, set switches 1-4 to the corresponding up and down positions shown for that house code.
5. Slide the battery cover back into place until it snaps closed.
6. Go to the main room and press the Setup button on the control console.
7. Select Homewide.
8. Select the Standard house code mode.
9. Return to the expansion room and press the Stop button (■) on the RC-35S2 remote.

The house code in your LIFESTYLE® system is now the same as in the RC-35S2 remote control.

# REFERENCE

## Troubleshooting

Problem	What to do
System not responding to controls	<ul style="list-style-type: none"> <li>• Make sure the RC-35S2 remote and the main room system have the same house code. See “Getting the remote ready” on page 3.</li> <li>• Make sure the RC-35S2 remote and the expansion system have the same room code. See “Getting the remote ready” on page 3.</li> </ul>
A device is not responding to remote control commands	<ul style="list-style-type: none"> <li>• Make sure the device is on.</li> <li>• Install an IR blaster in the main room.</li> </ul>
Intermittent operation using the RC-35S2 remote	<ul style="list-style-type: none"> <li>• Check the batteries to see if they need changing.</li> <li>• Move the remote to a different location to see if the problem is simply caused by “dead spots” in the building.</li> </ul>
System turns on or off, or changes sources unexpectedly when no buttons on the RC-35S2 remote have been pressed	<ul style="list-style-type: none"> <li>• Check to see if someone in the main room is using the primary remote control in that way.</li> <li>• You may be experiencing a control conflict with another LIFESTYLE® system near your home. Change the house code. See “Changing the house code” on page 9.</li> </ul>

## Customer service

For questions about the RC-35S2 remote or LIFESTYLE® system expansion, contact your local Bose dealer.

To contact Bose directly, see the address list included with your LIFESTYLE® system or visit <http://owners.Bose.com>.

## Technical information

**Remote control range:** 65 ft (20 m)

**Size:** 1.0"H x 2.3"W x 7.7"L  
(2.5 cm x 5.8 cm x 19.5 cm)

**Weight:** 6.9 oz (195 g)

**Battery type:** AAA or IEC-LR3 1.5V batteries (4)

**Frequency:** U.S./Canada/other: 27.145 MHz  
EU/other: 40.685 MHz





324085-0010

***BOSE***<sup>®</sup>  
*Better sound through research*<sup>®</sup>

©2010 Bose Corporation, The Mountain,  
Framingham, MA 01701-9168 USA  
AM324085 Rev.01